

2N Helios

Telephone based door entry solution



- ★ Unique design
- ★ Communication over telecom base lines
- ★ Calling from entrance door to your office telephones
- ★ Door opening from standard or mobile telephone, by key code or proximity card
- ★ Modular system – possibility of upgrading basic modules by camera, display & access control, system

2N Helios is a door entry system which meets the highest demands and is of a modern design. This user-friendly door phone replaces door systems and offers many additional features.

2N Helios can be connected to any analog PBX extension available on the market. As a result of its modularity it enables the creation of customised solutions according to the user's needs, not only in terms of its size, but also with various control elements and functions. Each basic module can be equipped with a camera, display or card reader and an anti-vandal solution against damage. 2N Helios is made of high-quality stainless steel, and its flat design makes possible installation without cutting into the wall. The main advantages of 2N Helios door entry solution include easy installation, state of art functions and a modern design.



Button telephone:



Using the keypad you can dial any number. Tone and pulse dialling is available. It is possible to restrict authorisation for calls to the public telephone network at the PBX.

Code lock:



You can control the connected electric lock directly from the door. It is possible to define up to ten passwords with a length from 1 to 16 digits. The parameter of the period for which the switch is closed can also be set.

Card reader:



An installed card reader offers another resource for access to your building. Up to 750 proximity cards or key fobs are available. If you connect the reader module to your PC, you can check the entries and departures of the individual card holders. If the door is forced, you will receive an alarm announcement.

Additional switch:



This is an excellent resource for controlling a second appliance (one switch is integrated into every basic module). Closing and opening contacts are available. This switch also enables switching for an unlimited period or for the time of call duration. The additional switch can be used, for example, for switching on the light in the vestibule / corridor.

Video:



A connected video camera makes possible visual inspection of those entering the building. The picture can be sent either to your PC or the connected LCD display or TV set. At night a good picture is ensured by switching to the black and white mode and also infrared illumination.

Display:



The display provides you with the possibility of selecting the numbers using the telephone book. Up to one thousand items are available, and you can upload them from your PC via a USB interface. Company logos or other graphics can be allocated to the individual items. Display also gives you the opportunity to completely service the unit.

Voice programming menu:



For simple programming, a voice menu is implemented which navigates you through the setting of the individual parameters. It is possible to hear the current parameters settings and the scope of possible values which can be saved.



How does 2N Helios work?

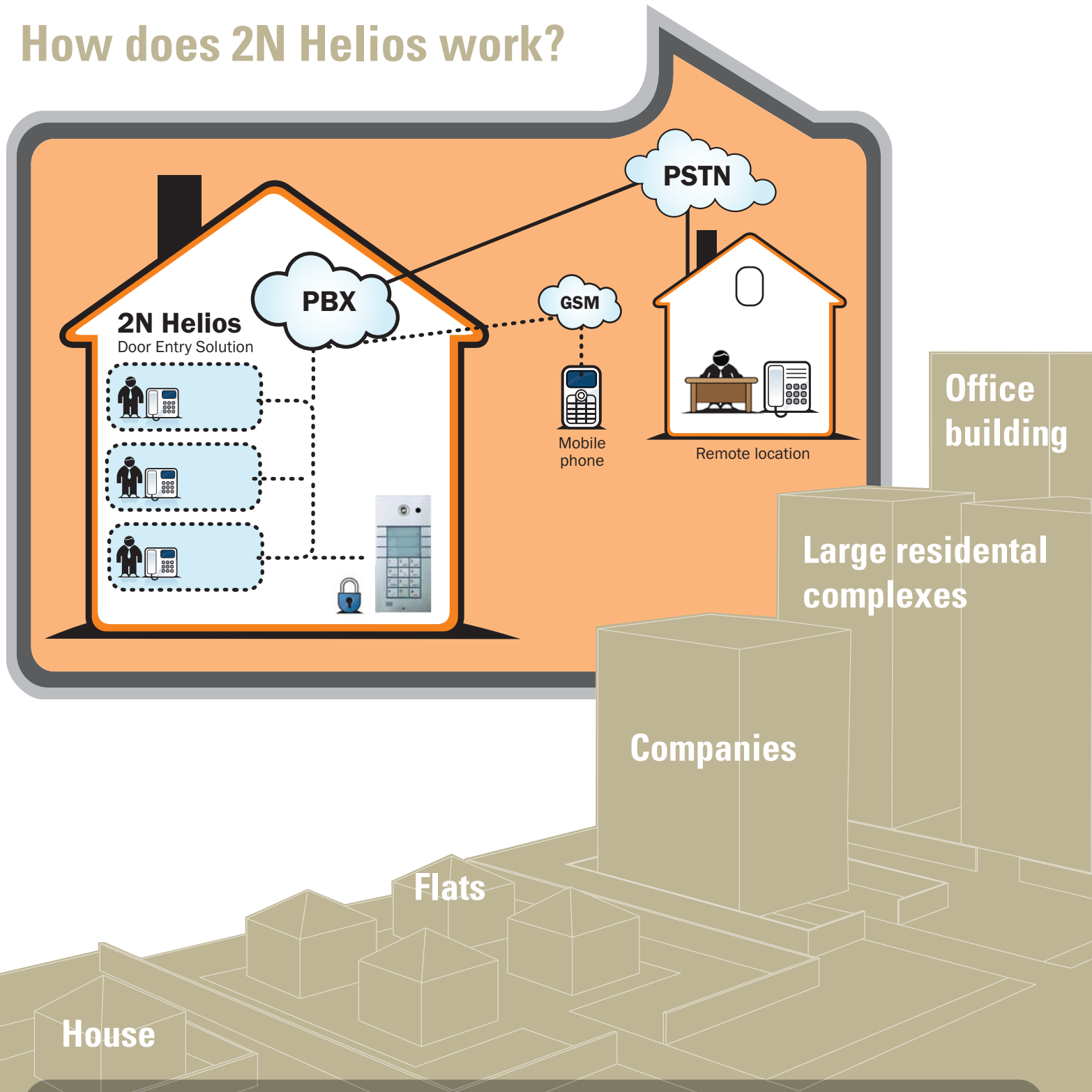

Who is 2N Helios Intended for?

- Residential houses & gated communities
- Public sector
- Schools & universities
- Hospitals & military bases
- Manufacturing facilities & distribution centres

HELIOS



1. Office building

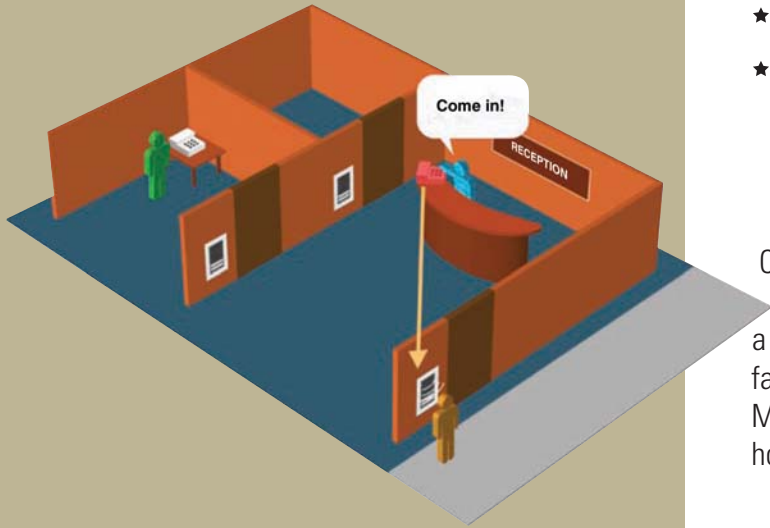

- ★ Telephone based door entry solution
- ★ Remote door opening
- ★ Cost saving on wire installation

Call from the entrance is transferred to the extension through internal telephone system. From the telephone can be entered a code for door opening for the visitor. Suitable solution to all facilities that are equipped with any kind of telephone system. Most desired solution for office buildings, government properties, hospitals, hotels and others.

2. Access control



- ★ Quick door opening for authorized users
- ★ Numerical keypad also works as the code lock
- ★ Sophisticated access control solution by build in proximity card reader

Want to monitor your visitors or tenants access? An entrance door or gate can be opened during the call by entering a code on the keypad of a standard telephone or mobile phone. As a resident by knowing the code for entering, you can type the code directly on the entrance panel for access. More sophisticated solution for access can be a proximity card or key fobs where reader is hidden inside of a 2N Helios entrance panel. You can link our proximity reader back to central software to provide you with more features and vital statistics.

3. Automation



- ★ Wireless communication suitable for remote gates, entrances and help points
- ★ Available at any time through GSM network
- ★ Entrance opening from mobile phone

After pressing the button, 2N Helios GSM solution allows you to wirelessly dial any mobile phone or a land line telephone in your premises and grant access to your visitor regardless of your location. This means there is no limit on distance and with the elimination of wires, gives you an easy installation.

Case studies

Basic modules



9135110E **9135130E** **9135160E** **9135110KE** **9135130KE** **9135160KE**

1 button 3 buttons 6 buttons 1 button and keypad 3 buttons and keypad 6 buttons and keypad

100 x 210 x 29 mm

Extender modules



9135181E **9135182E** **9135310E**

Extender 8 buttons Extender 16 buttons Infopanel without buttons

100 x 210 x 29 mm

Roofs, boxes



9135331E

Roof for 1 module
103 x 218 x 60 mm



9135332E

Roof for 2 modules
203 x 218 x 60 mm

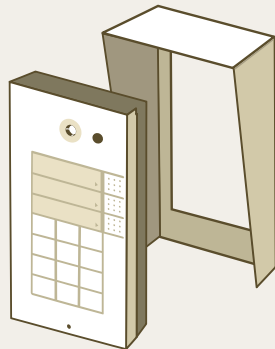

9135351E

Flush fixed box for 1 module
125 x 235 x 46 mm
Hole: 110 x 220 x 50 mm



9135352E

Flush fixed box for 2 modules
225 x 235 x 46 mm
Hole: 210 x 220 x 50 mm

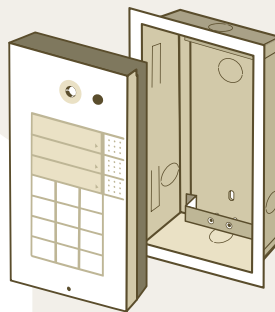

9135361E

Roof & box for masonry fitting - 1 module

129 x 240 x 41 mm
Hole: 110 x 220 x 50 mm



9135362E

Roof & box for masonry fitting - 2 modules

229 x 240 x 41 mm
Hole: 210 x 220 x 50 mm

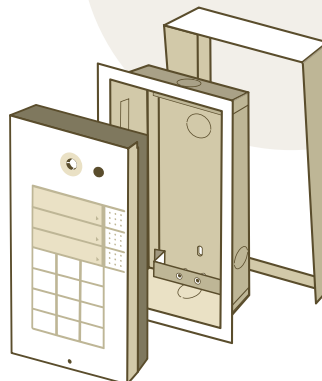

Vandal resistant masks, boxes



9135511E

Vandal resistant mask and box for masonry fitting

Mask: 138,5 x 241 mm
Hole: 110 x 220 x 50 mm



9135511KE

Vandal resistant mask with keypad and box for masonry fitting

Mask: 138,5 x 241 mm
Hole: 110 x 220 x 50 mm



9135515E

Vandal resistant mask for extender and box for masonry fitting

Mask: 138,5 x 241 mm
Hole: 110 x 220 x 50 mm

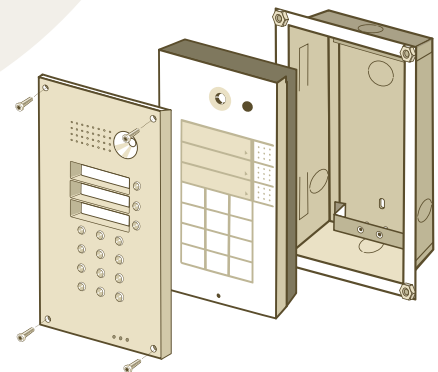

Additional modules



9135210E

Video camera



9135250E

Additional switch



9135240E

Display

Accessories



9135301E

Name plate



9135302E

Doublebutton name plate

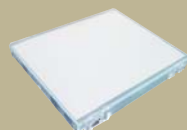

9135311E

Infopanel name plate

Complimentary products



9134145E

Video server MPEG4/LAN



9134147E

LCD display 7



91341481E

12V/2A stabilised power supply

2N Helios modular system

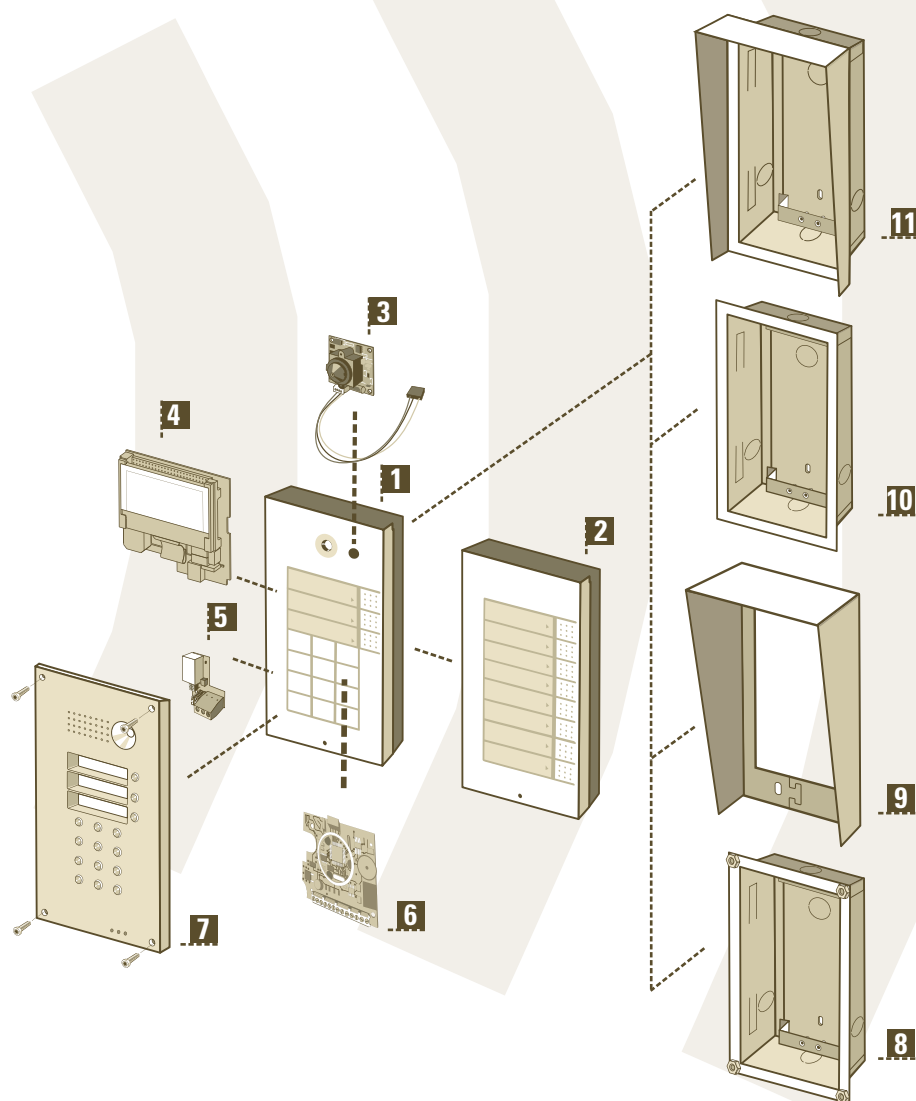

1. Basic module

- 1 button
- 3 buttons
- 6 buttons
- 1 button and keypad
- 3 buttons and keypad
- 6 buttons and keypad

2. Extender

- 8 buttons
- 16 buttons
- infopanel without buttons

3. Video camera

4. Display

5. Additional switch

6. Card reader

7., 8. Vandal resistant mask, Box for masonry fitting

- for basic module
- for basic module and keypad
- for extender

9. Roof

- for 1 module
- for 2 modules

10. Flush fixed box

- for 1 module
- for 2 modules

11. Roof and box for masonry fitting

- for 1 module
- for 2 modules

Technical parameters

2N Helios			
Number of buttons	1-54	Cover	External environment with sufficient rain protection
Connection with PBX	FXS – (internal) analogue telephone line according to standards CCITT	Operational temperature range	-20 - +60 °C
Power supply	From telephone line	Switch – max. voltage/current	max. 48 V / 1 A AC
DC voltage drop	< 8 V (I = 25 mA)	Dimensions (1 module)	210 x 100 x 29 mm (H x W x D)
(off-hook)	< 16 V (I = 50 mA)	Weight	max. 500 g
Dialling	impulse / tone	Coverage	IP 53
Backlight – rated voltage	12 V		